



70-400-85S

SMOOTH TOP & SIDES

CLOSURE SPECIFICATIONS

Diameter: 70 mm
Thread Profile: 400
Neck Finish: 70-400
Closure Top: Smooth
Closure Sidewall: Smooth
Material: PP

PRODUCT BENEFITS

- » Smooth top and sides lend a "clean" look to the package
- » Popular for vitamins and nutraceuticals
- » Popular for cosmetics

MARKETS

- » Nutraceuticals
- » Personal Care/Cosmetics
- » Pharmaceuticals

OPTIONS

- » Available in white, several standard colors and custom colors
- » Can be lined with a wide variety of liner systems including SureSeal (foam), pressure sensitive and heat induction (foil) liners
- » Off-set printing is available on this closure in up to three colors

PACKAGING & FREIGHT INFORMATION

PACK TYPE	PCS/CTN	CTNS/PALT	PCS/PALT	CTN WT*	PALT WT*	FRT CLASS
Bulk	1,000	15	15,000	25.1817 (1)	377.7255 (1)	125.0 (1)
Bulk	1,000	15	15,000	27.8046 (2)	417.0690 (2)	100.0 (2)

CARTON DIMENSIONS

24 x 16 x 15

PALLET DIMENSIONS

48 x 40 x 50

(1) Unlined Closures (2) Lined Closures * Approximate

LOCATIONS

NAPERVILLE, IL • NEWPORT, TN • DAVENPORT, IA
 GREENCASTLE, IN • ONTARIO, CA • STAINES, UK



Phoenix Closures, Inc.

Quality and Innovation Since 1890

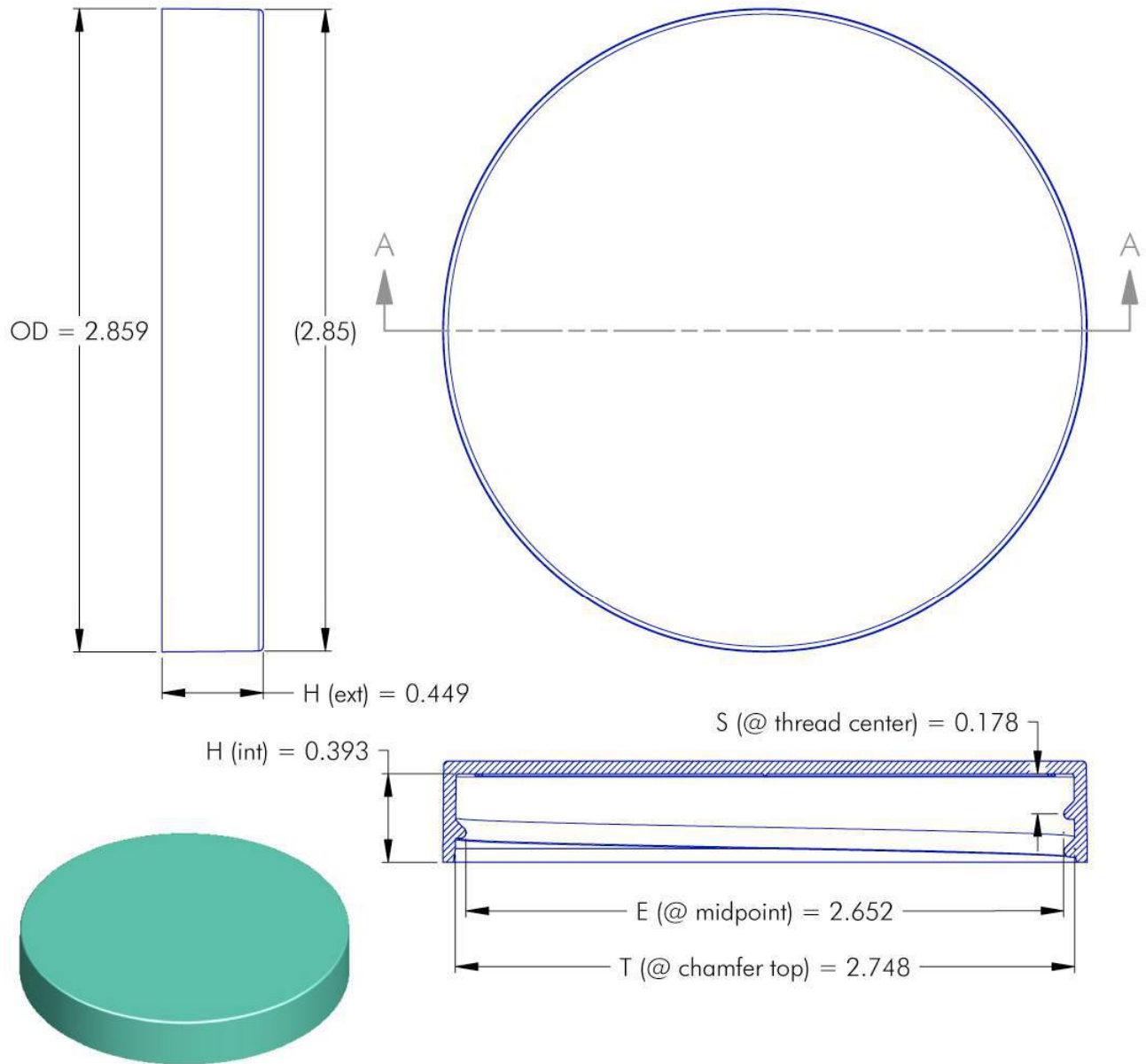

NOTES: (UNLESS OTHERWISE SPECIFIED)
 1. ALL DIMENSIONS ARE IN INCHES.
 2. TOLERANCE ON ALL DIMENSIONS IS ± 0.010 ".

#	00.00.00	-	--	PITCH (TPI): 6	# OF TURNS: 1-1/8	MATERIAL: POLYPROPYLENE
REV	DATE	DESCRIPTION	BY	DRAWING #: 70 - 400 - 85S		SCALE: 1-1/2 : 1
THIS OR FACSIMILE THEREOF IS THE EXCLUSIVE PROPERTY OF PHOENIX CLOSURES, INC. AND MAY NOT BE REPRODUCED WITHOUT THE EXPRESSED WRITTEN CONSENT OF PHOENIX CLOSURES, INC. SOME OR ALL OF THE ITEMS DEPICTED ON THIS DRAWING MAY BE COVERED BY CURRENT PATENTS OR PATENTS APPLIED FOR BY PHOENIX CLOSURES, INC.				DESCRIPTION: OVERALL SMOOTH FINISH / SHALLOW SKIRT		
				DRAWN BY: DMN	DATE: 10.03.03	APPROVED BY: LRE



Phoenix Closures, Inc.

Quality and Innovation Since 1890

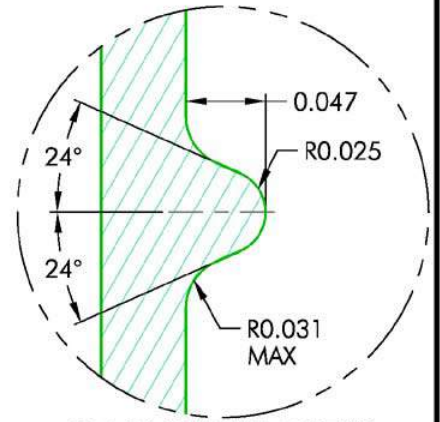
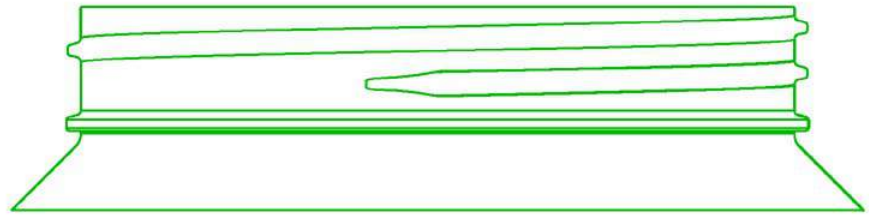
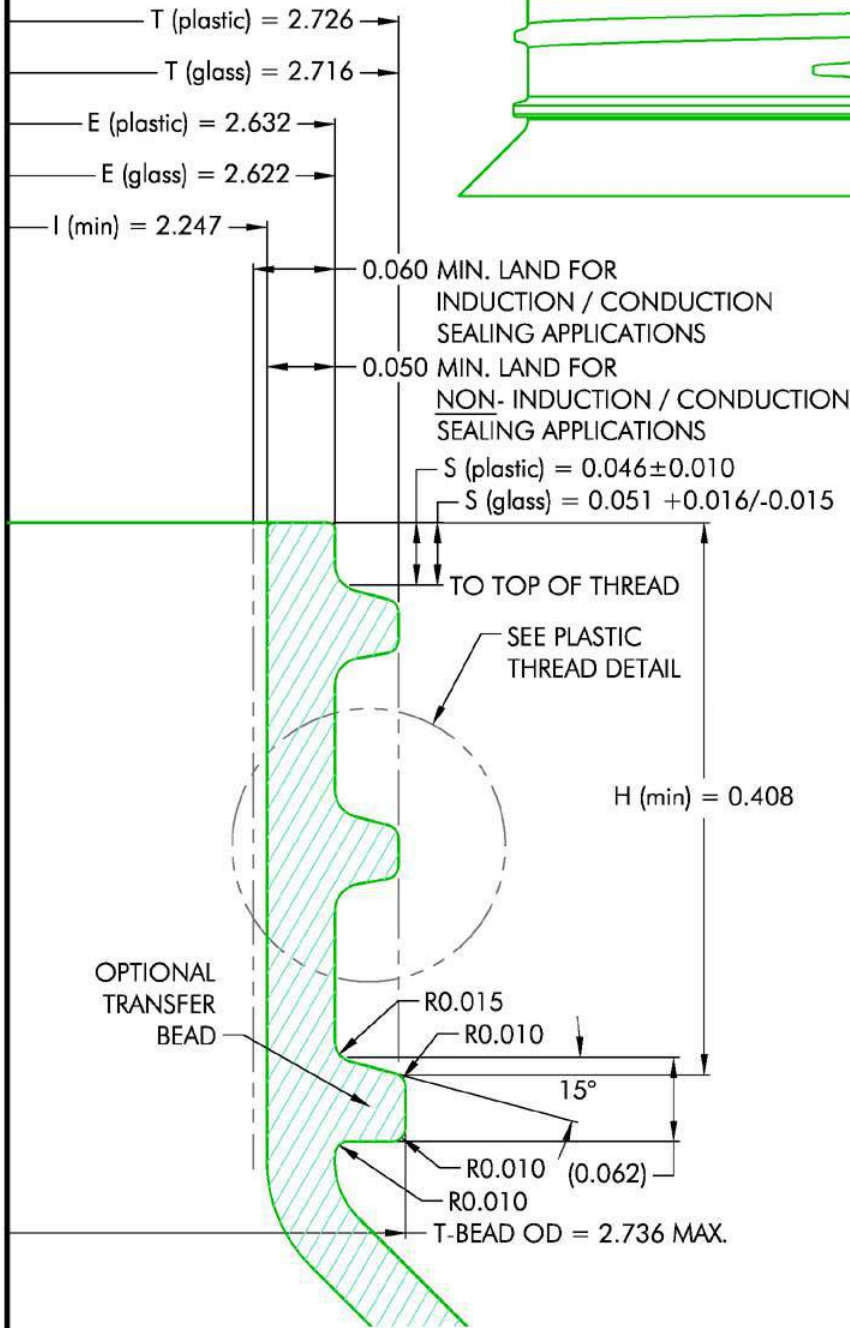

GLASS THREAD DETAIL
SCALE 10 : 1

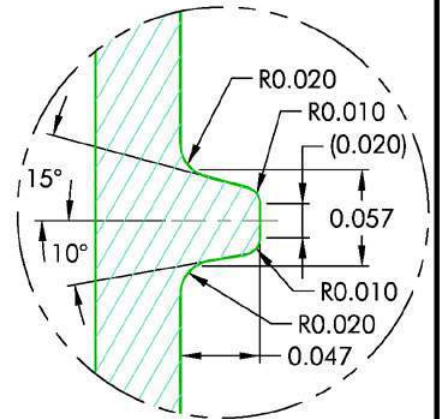

PLASTIC THREAD DETAIL
SCALE 10 : 1

MATERIAL	TOLERANCE
PP / PE	± 0.010
PET	± 0.010
GLASS	± 0.020

NOTES: (UNLESS OTHERWISE SPECIFIED)

- ALL DIMENSIONS ARE IN INCHES.
- TOLERANCE ON ALL DIMENSIONS GIVEN BY CHART.

#	00.00.00		
REV	DATE	DESCRIPTION	BY

THIS OR FACSIMILE THEREOF IS THE EXCLUSIVE PROPERTY OF PHOENIX CLOSURES, INC. AND MAY NOT BE REPRODUCED WITHOUT THE EXPRESSED WRITTEN CONSENT OF PHOENIX CLOSURES, INC.

PITCH (TPI): 6	# OF TURNS: 1-1/4	MATERIAL: PER CHART
DRAWING #: 70-400-FINISH		
DESCRIPTION: FINISH FOR USE WITH PCI 70-400 CLOSURES		
FILE: 70-400-FINISH.dwg	SCALE: 8 : 1	
DRAWN BY: BEZ	DATE: 04.15.97	APPRVD BY: LRE
	REV: 0	BF