



58-400-85S

SMOOTH TOP & SIDES

CLOSURE SPECIFICATIONS

Diameter: 58 mm
Thread Profile: 400
Neck Finish: 58-400
Closure Top: Smooth
Closure Sidewall: Smooth
Material: PP

PRODUCT BENEFITS

- » Smooth top and sides lend a "clean" look to the package
- » Popular for vitamins and nutraceuticals
- » Popular for cosmetics

MARKETS

- » Nutraceuticals
- » Personal Care/Cosmetics
- » Pharmaceuticals

OPTIONS

- » Available in white, several standard colors and custom colors
- » Can be lined with a wide variety of liner systems including SureSeal (foam), pressure sensitive and heat induction (foil) liners
- » Off-set printing is available on this closure in up to three colors

PACKAGING & FREIGHT INFORMATION

| PACK TYPE | PCS/CTN | CTNS/PALT | PCS/PALT | CTN WT* | PALT WT* | FRT CLASS |
|-----------|---------|-----------|----------|-------------|--------------|-----------|
| Bulk | 1,650 | 15 | 24,750 | 27.1428 (1) | 407.1420 (1) | 100.0 (1) |
| Bulk | 1,650 | 15 | 24,750 | 29.9715 (2) | 449.5725 (2) | 100.0 (2) |

CARTON DIMENSIONS

24 x 16 x 15

PALLET DIMENSIONS

48 x 40 x 50

(1) Unlined Closures

(2) Lined Closures

* Approximate

LOCATIONS

NAPERVILLE, IL • NEWPORT, TN • DAVENPORT, IA
 GREENCASTLE, IN • ONTARIO, CA • STAINES, UK



Phoenix Closures, Inc.

Quality and Innovation Since 1890

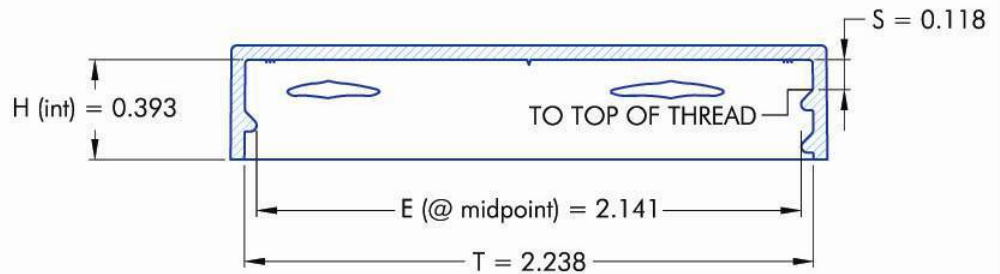
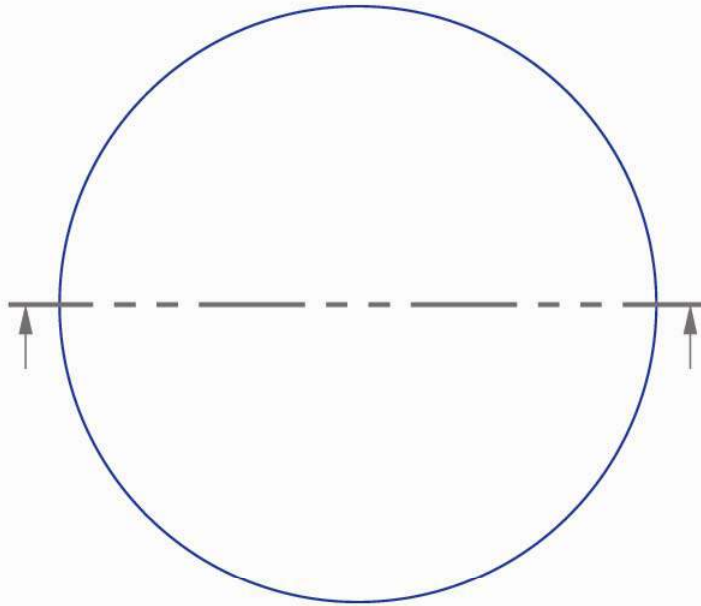
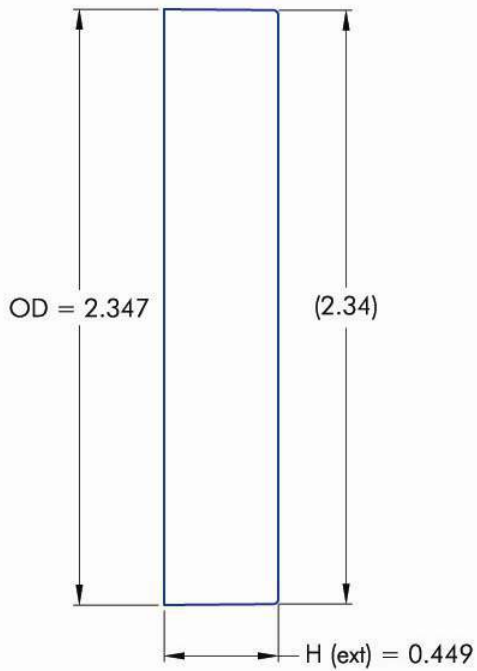

NOTES: (UNLESS OTHERWISE SPECIFIED)

1. ALL DIMENSIONS ARE IN INCHES.
2. TOLERANCE ON ALL DIMENSIONS IS ± 0.010 INCHES.

| REV | DATE | DESCRIPTION | BY |
|-----|------|-------------|----|
| | | | |

THIS OR FACSIMILE THEREOF IS THE EXCLUSIVE PROPERTY OF PHOENIX CLOSURES, INC. AND MAY NOT BE REPRODUCED WITHOUT THE EXPRESSED WRITTEN CONSENT OF PHOENIX CLOSURES, INC.

| | | |
|------------------------------|-------------------|-------------------------|
| PITCH (TPI): 6 | # OF TURNS: 1-1/8 | MATERIAL: POLYPROPYLENE |
| DRAWING #: | | 58-400-85 (S) |
| DESCRIPTION: | | |
| OVERALL SMOOTH TOP AND SKIRT | | |
| FILE: | 58-400-85S-R1.dwg | SCALE: 1-1/2 : 1 |
| DRAWN BY: BEZ | DATE: 03.23.95 | APPRVD BY: LRE |
| REV: 1 | WP | |



Phoenix Closures, Inc.

Quality and Innovation Since 1890

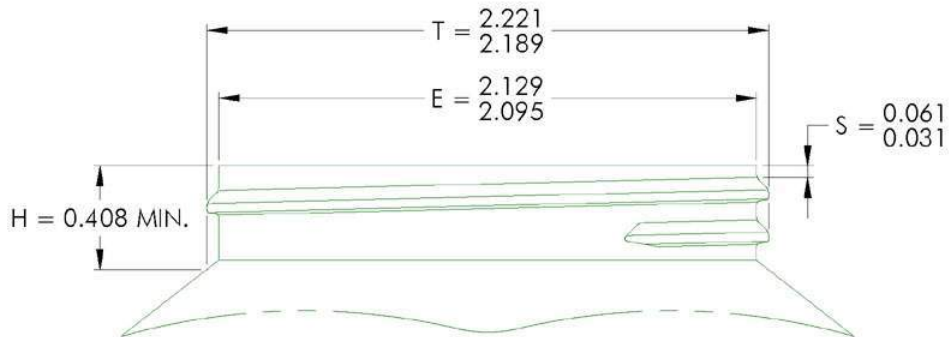
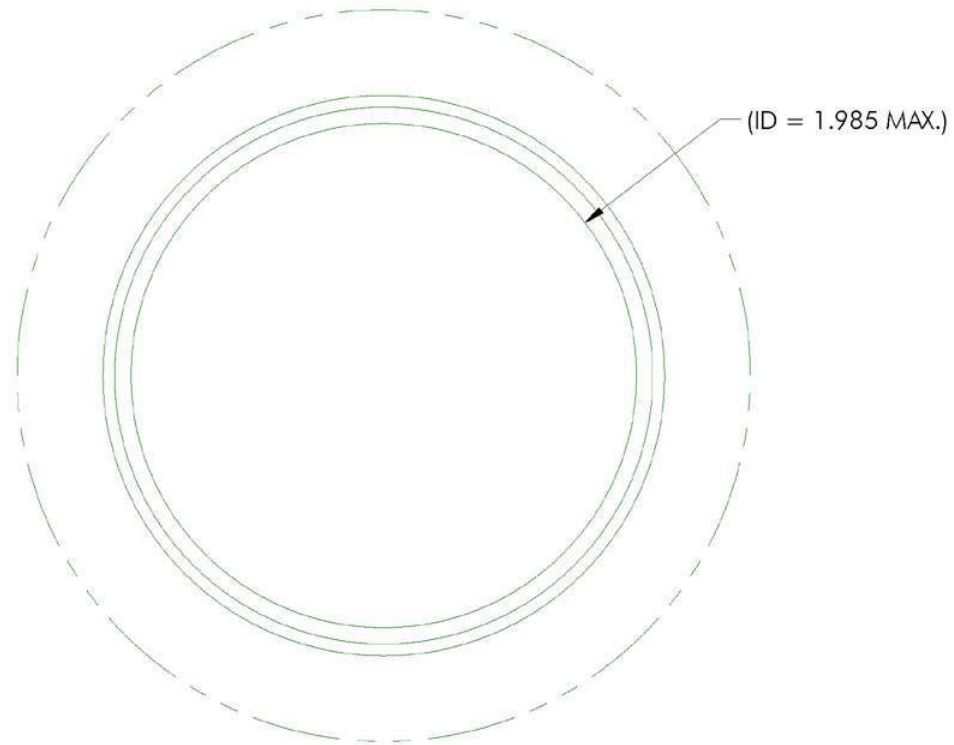

NOTES: (UNLESS OTHERWISE SPECIFIED)

1. ALL DIMENSIONS ARE IN INCHES.

| REV | DATE | DESCRIPTION | BY |
|-----|------|-------------|----|
| - | - | - | - |

THIS OR FACSIMILE THEREOF IS THE EXCLUSIVE PROPERTY OF PHOENIX CLOSURES, INC. AND MAY NOT BE REPRODUCED WITHOUT THE EXPRESSED WRITTEN CONSENT OF PHOENIX CLOSURES, INC.

| | | | | | |
|--------------|----------------------------------|-------------|----------|--------|-------------------|
| PITCH (TPI): | 6 | # OF TURNS: | 1-1/8 | FILE: | 58-400-FINISH.dwg |
| DRAWING #: | 58-400 CONTAINER FINISH | | | | |
| DESCRIPTION: | FOR USE WITH PCI 58-400 CLOSURES | | | | |
| DRAWN BY: | D. NICKERSON | DATE: | 07.26.02 | SCALE: | 1-1/2 : 1 |
| APPRVD BY: | L. EKKERT | DATE: | 07.31.02 | REV: | 0 BF |