



70-TAB-4901S

**MEDIUM & DEEP
SKIRTED CLOSURES**

CLOSURE SPECIFICATIONS

Diameter: 70 mm
Thread Profile: TAB
Neck Finish: 70-TAB
Closure Top: Stipple
Closure Sidewall: Broad Ribbed
Material: PP

PRODUCT BENEFITS

- » Broad-ribbed sides are easier to grip
- » Popular for peanut butter and nuts

MARKETS

- » Dressings & Sauces
- » Food
- » Food Service
- » Peanut Butter & Nuts
- » Powdered Drinks

OPTIONS

- » Available in white, several standard colors and custom colors
- » Can be lined with a wide variety of liner systems including SureSeal (foam), pressure sensitive and heat induction (foil) liners
- » This closure can be embossed/debossed with your custom message
- » Offset printing is available on this closure in up to three colors

PACKAGING & FREIGHT INFORMATION

PACK TYPE	PCS/CTN	CTNS/PALT	PCS/PALT	CTN WT*	PALT WT*	FRT CLASS
Bulk	650	15	9,750	21.7877 (1)	326.8155 (1)	125.0 (1)
Bulk	650	15	9,750	22.3284 (2)	334.9260 (2)	125.0 (2)

CARTON DIMENSIONS

24 x 16 x 15

PALLET DIMENSIONS

48 x 40 x 50

(1) Unlined Closures (2) Lined Closures * Approximate

LOCATIONS

NAPERVILLE, IL • NEWPORT, TN • DAVENPORT, IA
 GREENCASTLE, IN • ONTARIO, CA • STAINES, UK



Phoenix Closures, Inc.

Quality and Innovation Since 1890

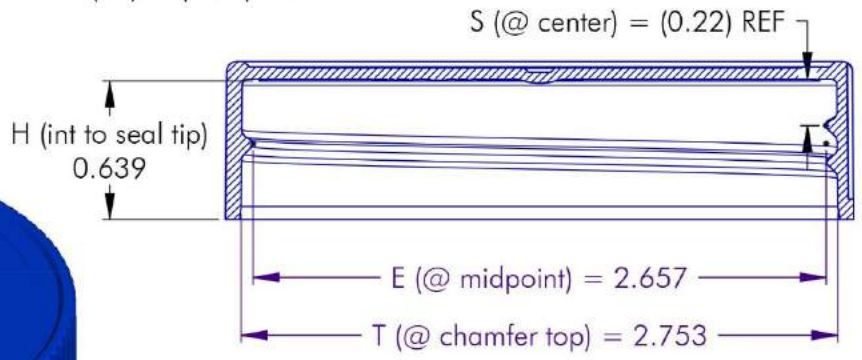
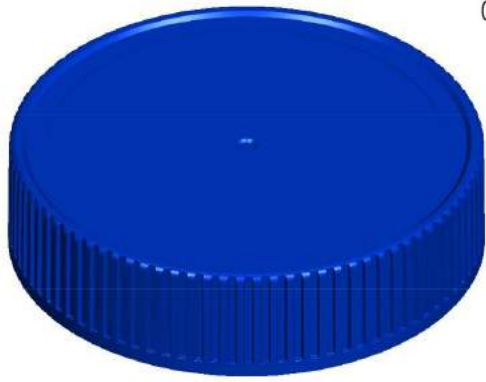
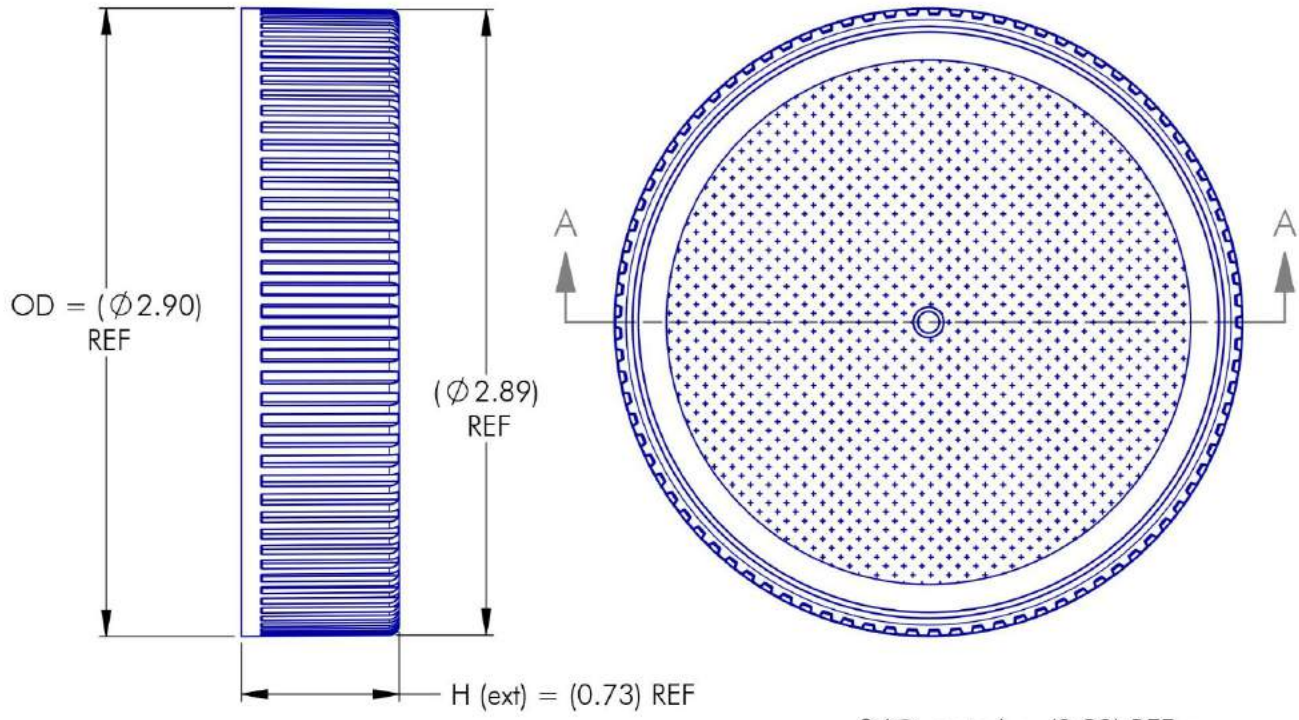

NOTES: (UNLESS OTHERWISE SPECIFIED)

1. ALL DIMENSIONS ARE IN INCHES.

2. TOLERANCE ON ALL DIMENSIONS IS ± 0.010 " EXCEPT WHERE NOTED AS "REF".

QA NOTES: (UNLESS OTHERWISE SPECIFIED)

1. ADDED 09.20.05 (DMN): MAXIMUM CONCAVITY (SINK) IS 0.070".

6	02.02.15	ADDED APPROPRIATE "REF" DIMENSIONS	DN	PITCH (TPI): 6	# OF TURNS: 1-1/4	MATERIAL: POLYPROPYLENE
REV	DATE	DESCRIPTION	BY	DRAWING #: 70 - TAB - 4901(S)		SCALE: 1-1/4 : 1
<p>THIS OR FACSIMILE THEREOF IS THE EXCLUSIVE PROPERTY OF PHOENIX CLOSURES, INC. AND MAY NOT BE REPRODUCED WITHOUT THE EXPRESSED WRITTEN CONSENT OF PHOENIX CLOSURES, INC. SOME OR ALL OF THE ITEMS DEPICTED ON THIS DRAWING MAY BE COVERED BY CURRENT PATENTS OR PATENTS APPLIED FOR BY PHOENIX CLOSURES, INC.</p>				DESCRIPTION: BROAD RIB / MATTE FINISH TOP / TRI-TAB		
				DRAWN BY: DMN	DATE: 12.03.03	APPROVED BY: LRE



Phoenix Closures, Inc.

Quality and Innovation Since 1890

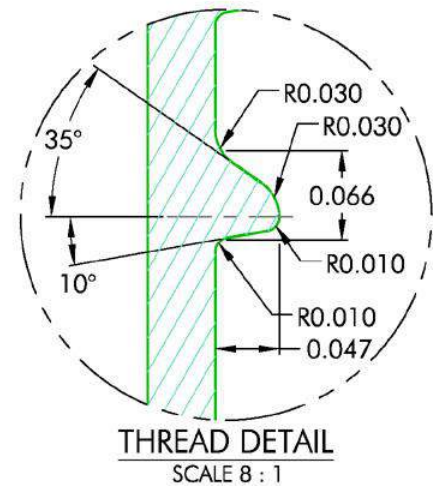
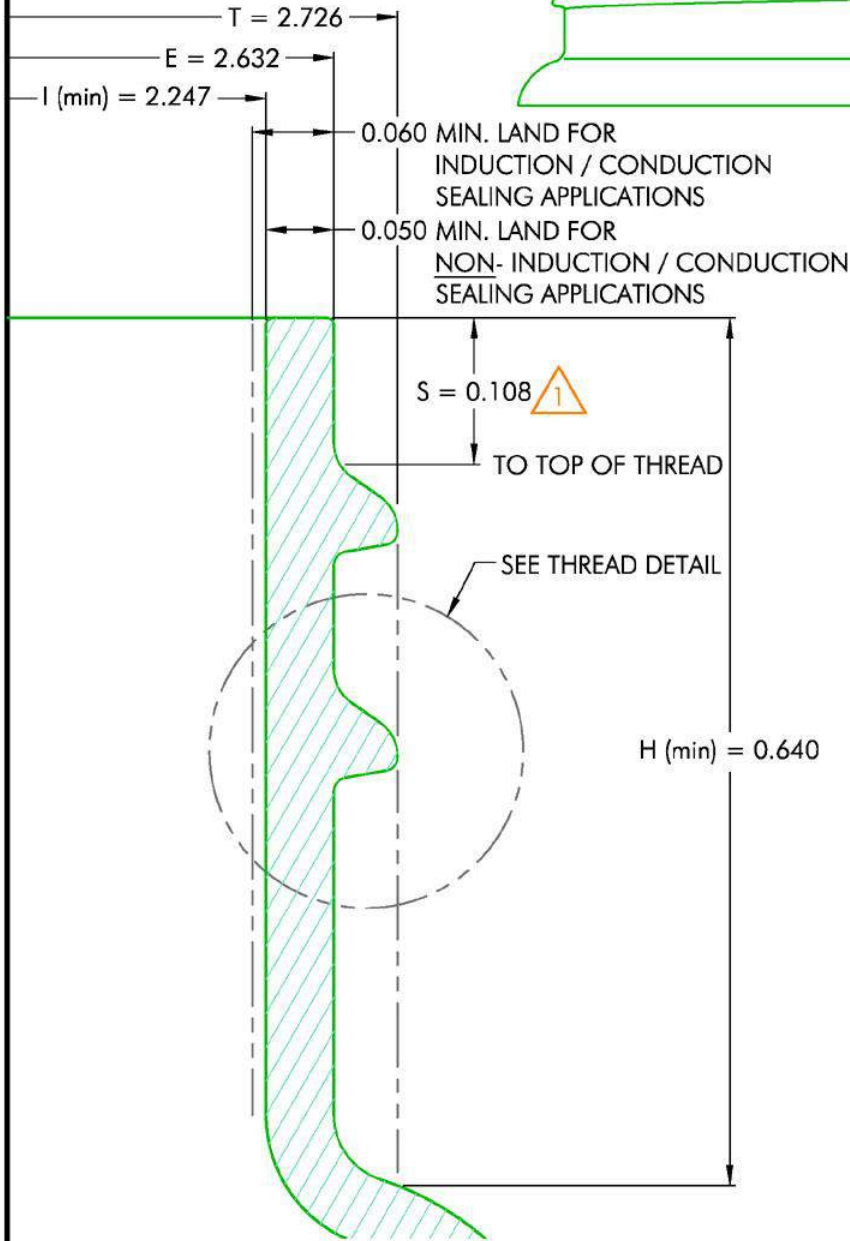
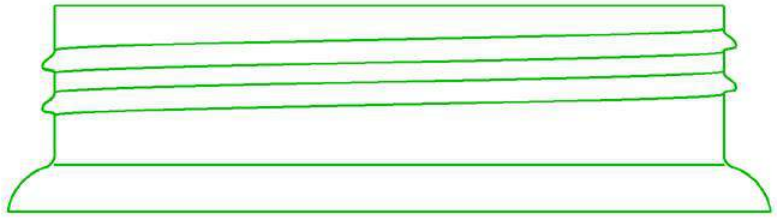

MATERIAL	TOLERANCE
PP / PE	-
PET	± 0.010
GLASS	-

NOTES: (UNLESS OTHERWISE SPECIFIED)
 1. ALL DIMENSIONS ARE IN INCHES.
 2. TOLERANCE ON ALL DIMENSIONS GIVEN BY CHART.

REV	DATE	DESCRIPTION	BY
1	11.28.01	CHG # OF TURNS FRM 1-1/4 & "S" DIM. FRM 0.123	BZ

THIS OR FACSIMILE THEREOF IS THE EXCLUSIVE PROPERTY OF PHOENIX CLOSURES, INC. AND MAY NOT BE REPRODUCED WITHOUT THE EXPRESSED WRITTEN CONSENT OF PHOENIX CLOSURES, INC.

PITCH (TPI): 6	# OF TURNS: 1-1/2	MATERIAL: PER CHART
DRAWING #: 70-TAB-FINISH		
DESCRIPTION: FINISH FOR USE WITH PCI 70-TAB CLOSURES		
FILE: 70-TAB-FINISH-R1.dwg	SCALE: 8 : 1	
DRAWN BY: BEZ	DATE: 03.20.97	APPRVD BY: LRE
	REV: 1	BF